

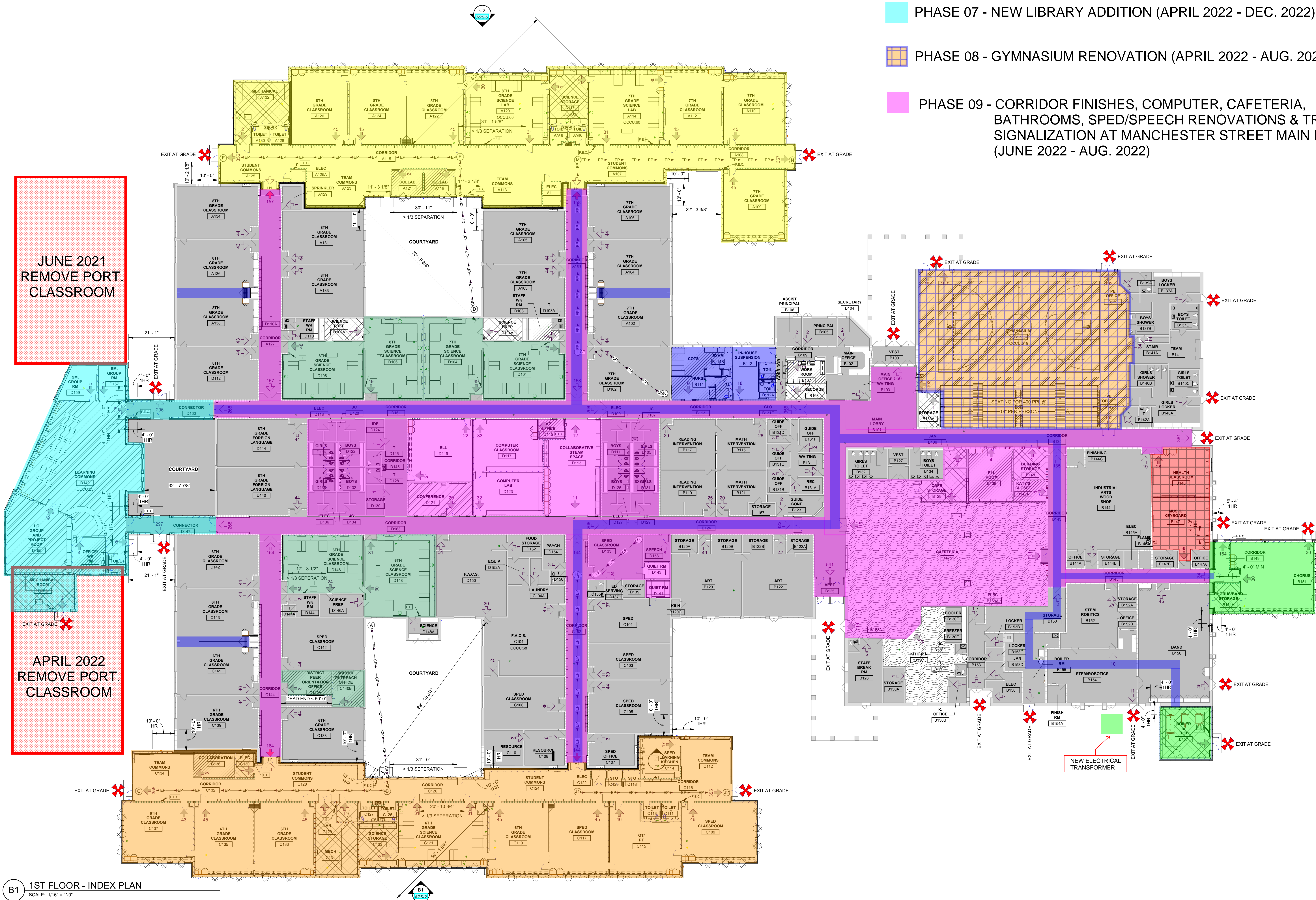

# PENNICHUCK MIDDLE SCHOOL CONSTRUCTION PHASING PLAN (2021-2022)

- PHASE 01 - SOUTH CLASSROOM ADDITION (MAY 2021 - MAR. 2022)
- PHASE 02 - BOILER, ELECTRICAL ROOM & CHORUS ADDITIONS (MAY 2021 - OCT. 2021)
- PHASE 03 - NORTH CLASSROOM ADDITION (JUNE 2021 - APRIL 2022)
- PHASE 04 - HW SUPPLY/RETURN MAINS IN CORRIDORS  
NURSE OFFICE RENOVATION & UPGRADED FOLDED PARTITIONS (JUNE 2021 - AUG. 2021)
- PHASE 05 - HEALTH & MUSIC/KEYBOARD RENOVATION (OCT. 2021 - JAN. 2022)
- PHASE 06 - SCIENCE ROOM, SCHOOL OUTREACH  
& DIST. PEER ORIENTATION UPGRADES (MAR. 2022 - SEPT./OCT. 2022)
- PHASE 07 - NEW LIBRARY ADDITION (APRIL 2022 - DEC. 2022)
- PHASE 08 - GYMNASIUM RENOVATION (APRIL 2022 - AUG. 2022)
- PHASE 09 - CORRIDOR FINISHES, COMPUTER, CAFETERIA,  
BATHROOMS, SPED/SPEECH RENOVATIONS & TRAFFIC  
SIGNALIZATION AT MANCHESTER STREET MAIN ENTRANCE (JUNE 2022 - AUG. 2022)



NASHUA SCHOOL DISTRICT  
PENNICHUCK MIDDLE SCHOOL  
ADDITIONS AND RENOVATIONS  
NASHUA, NEW HAMPSHIRE

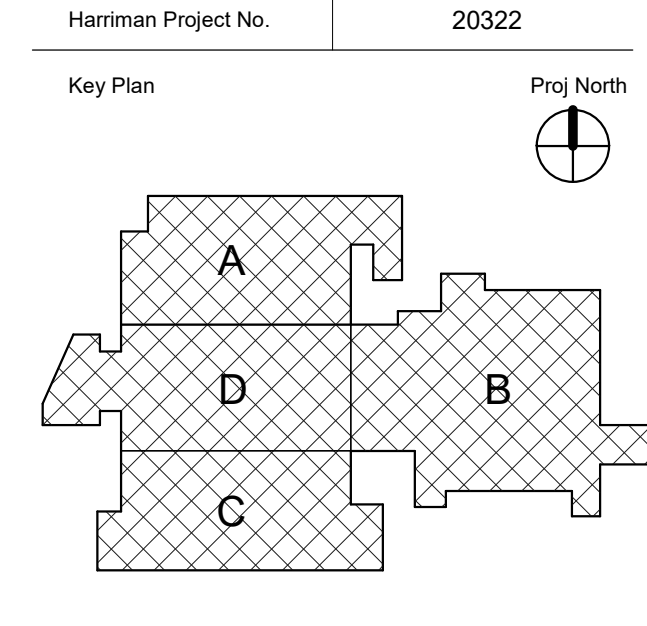

- ### GENERAL NOTES
- PATCH ALL EXISTING OPENINGS AND OPENINGS CREATED BY THE REMOVAL OF DUCTS, CONDUIT, PIPES ETC WITH MATERIALS TO MATCH ADJACENT CONSTRUCTION.
  - SMOKE AND FIRESTOP ALL FLOOR & WALL PENETRATIONS AT TOP OF WALL AND AROUND DUCTS, CONDUIT, PIPES ETC WITH A UL APPROVED ASSEMBLY. SEE CONSTRUCTION DETAILS ON SHEET A40.3.
  - ALL PATCHING AND FIRESTOPPING OF NEW HOLES, EXISTING HOLES BELOW THE EXISTING FINISH CEILING LINE AND HOLES CREATED FROM MECH, ELEC & MECH EQUIPMENT SHOWN TO BE REMOVED SHALL BE COVERED IN THE BASE BID.
  - PATCHING AND FIRESTOPPING OF EXISTING HOLES AND TOP OF WALL CONDITIONS, NOT NOTED ABOVE AND UNFIRESTOPPED SHALL BE ASSIGNED A UNIT COST AND PAID FOR WITH A PATCHING AND FIRESTOPPING ALLOWANCE.

- ### LIFE SAFETY PLAN LEGEND
- FIRE EXTINGUISHER CABINET
  - FIRE EXTINGUISHER WALL MOUNT
  - EXIT AT GRADE
  - ONE-WAY HORIZONTAL EXIT WITH OCCUPANT LOAD
  - TWO-WAY HORIZONTAL EXIT WITH OCCUPANT LOAD BOTH WAYS
  - COMMON PATH OF TRAVEL
  - EGRESS PATH
  - OCCUPANT LOAD AT OPENING
- SEE F SERIES DRAWINGS FOR ADDITIONAL FIRE PROTECTION INFORMATION
- SEE E SERIES DRAWINGS ADDITIONAL LIFE SAFETY LIGHTING AND EXIT SIGNAGE
- SEE E SERIES DRAWINGS FOR ADDITIONAL DOOR HARDWARE LIFE SAFETY, ADA AND SECURITY LOCATIONS

### CONSTRUCTION DOCUMENTS

DECEMBER 22, 2020

Rev	Date	Revision Description

PA/PE: MDL © 2021 Harriman Associates  
Drawn by: JDD

### FIRST FLOOR CODE AND INDEX PLAN

A01-1

B1 1ST FLOOR - INDEX PLAN  
SCALE: 1/16" = 1'-0"